



Light Switch H2 US – User Manual

For

Light Switch H2 US (2 Buttons, 1 Channel)

Light Switch H2 US (2 Buttons, 2 Channels)

Light Switch H2 US (4 Buttons, 3 Channels)

EN	Light Switch H2 US User Manual
FR	Manuel de l'utilisateur - Interrupteur H2 US
ES	Manual del Usuario - Interruptor H2 US
KR	라이트 스위치 H2 US – 사용 설명서
CN	美標牆壁開關H2-使用手冊
TH	สวิตช์ไฟ H2 US – คู่มือผู้ใช้
VI	Công tắc đèn H2 US – Hướng dẫn sử dụng

Product Introduction

Aqara Light Switch H2 US is a smart switch based on Thread/Zigbee wireless communication protocols which can control lights, automations, and scenes. When used with a hub, it can be controlled via the app, and has features for scheduling, power monitoring, power statistics, and other functions. It can also be used with other smart devices to enable a variety of interconnected control functions.

*This product needs to be used with a device that has Matter Border Router function.

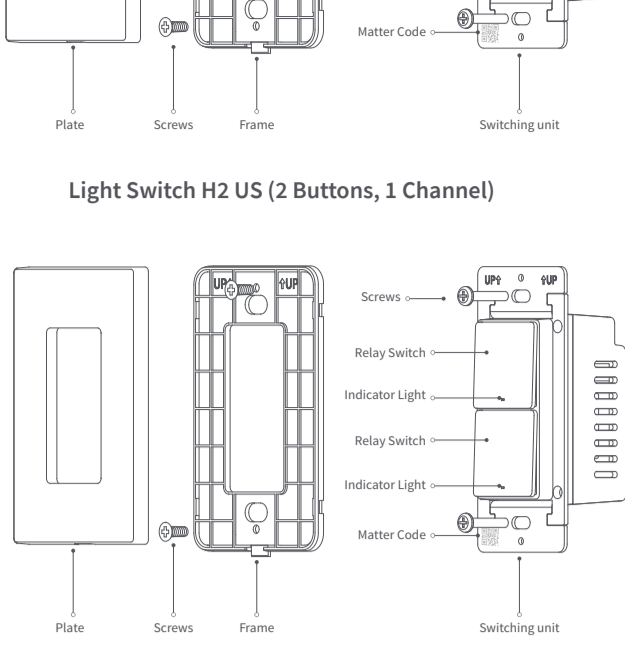

Light Switch H2 US (2 Buttons, 1 Channel)

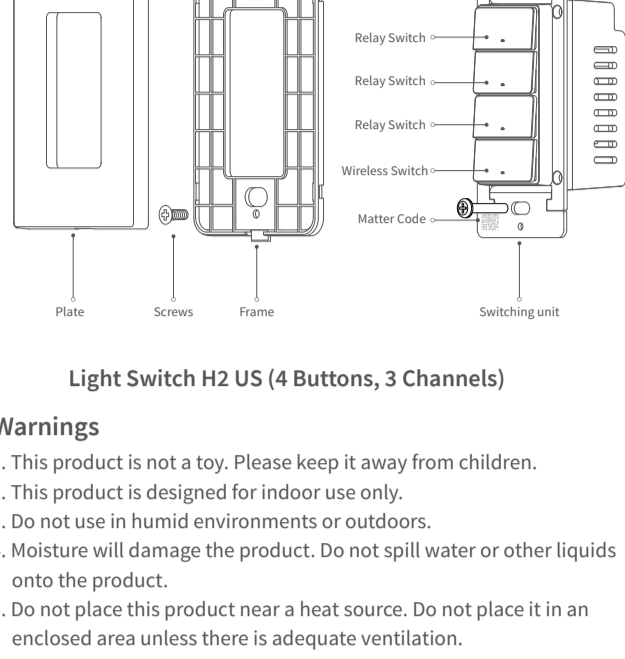

Light Switch H2 US (2 Buttons, 2 Channels)

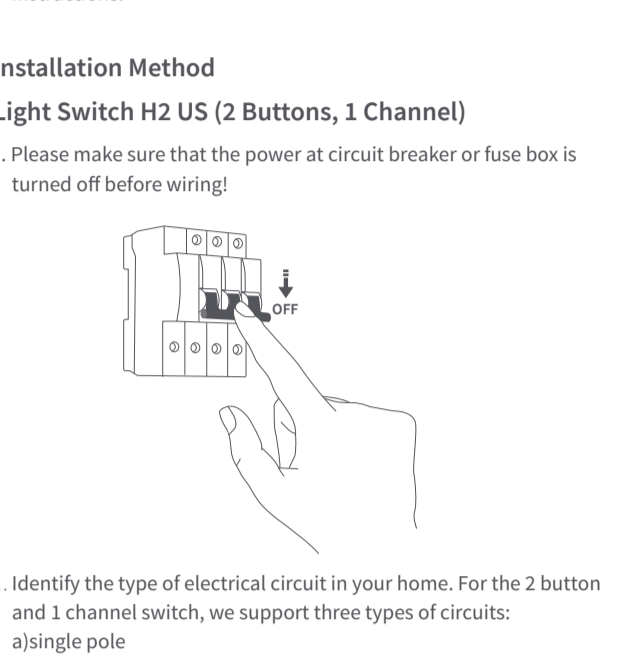

Light Switch H2 US (4 Buttons, 3 Channels)

Warnings

1. This product is not a toy. Please keep it away from children.
2. This product is designed for indoor use only.
3. Do not use in humid environments or outdoors.
4. Moisture will damage the product. Do not spill water or other liquids onto the product.
5. Do not place this product near a heat source. Do not place it in an enclosed area unless there is adequate ventilation.
6. Do not attempt to repair this product by yourself. All repairs should be performed by an authorized professional.
7. This product is suitable for home monitoring and smart home integration. The manufacturer is not responsible for any risks or property losses caused by misuse or failure to follow the product instructions.

Installation Method

Light Switch H2 US (2 Buttons, 1 Channel)

1. Please make sure that the power at circuit breaker or fuse box is turned off before wiring!

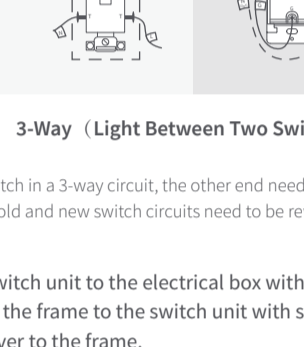

2. Identify the type of electrical circuit in your home. For the 2 button and 1 channel switch, we support three types of circuits:

- a) single pole
- b) 3-way (light outside two switches)
- c) 3-way (light between two switches)

Please follow the instructions below to determine your home's circuit type and wire it correctly. For 3-way circuit wiring, we recommend seeking assistance from a professional electrician.

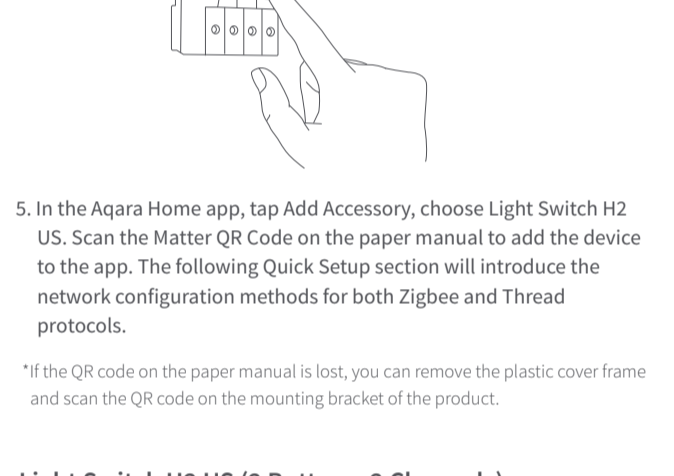

Single Pole Wiring

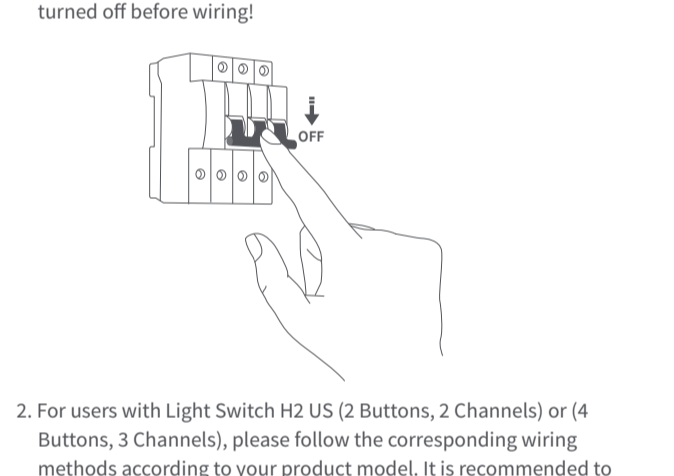

3-Way (Light Outside Two Switches)

* Use only one switch in a 3-way circuit, the other end needs to be a normal standard switch. Both the old and new switch circuits need to be rewired according to the diagram.

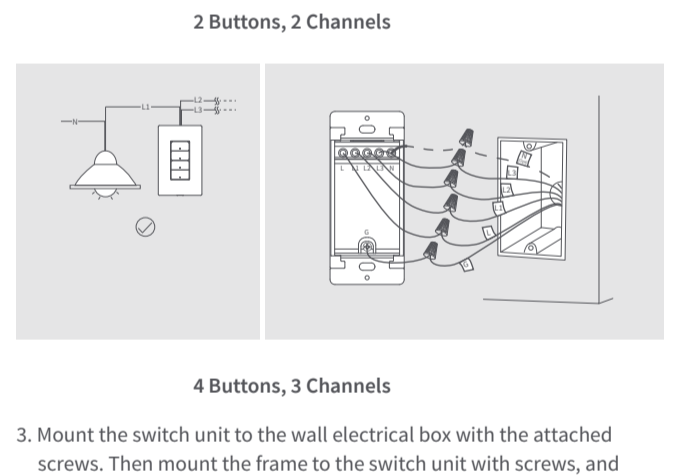

3-Way (Light Between Two Switches)

* Use only one switch in a 3-way circuit, the other end needs to be a normal standard switch. Both the old and new switch circuits need to be rewired according to the diagram.

3. Mount the switch unit to the electrical box with the attached screws. Then mount the frame to the switch unit with screws, and attach the faceplate cover to the frame.

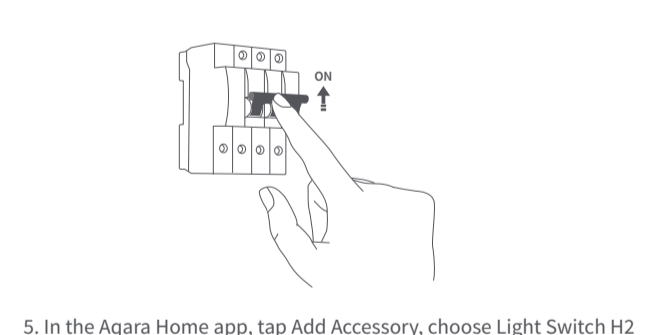

4. Turn on the power at the circuit breaker and test the switch by pressing the upper button. If the wired light can be controlled by the upper button, the switch is functioning correctly.

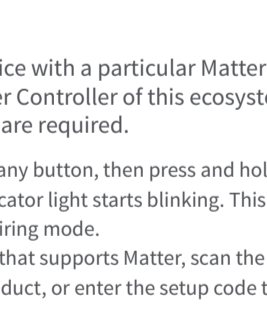

5. In the Aqara Home app, tap Add Accessory, choose Light Switch H2 US. Scan the Matter QR Code on the paper manual to add the device to the app. The following Quick Setup section will introduce the network configuration methods for both Zigbee and Thread protocols.

* If the QR code on the paper manual is lost, you can remove the plastic cover frame and scan the QR code on the mounting bracket of the product.

Light Switch H2 US (2 Buttons, 2 Channels)

Light Switch H2 US (4 Buttons, 3 Channels)

1. Please make sure that the power at circuit breaker or fuse box is turned off before wiring!

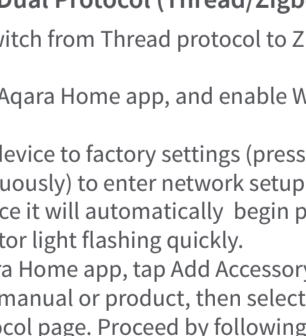

2. For users with Light Switch H2 US (2 Buttons, 2 Channels) or (4 Buttons, 3 Channels), please follow the corresponding wiring methods according to your product model. It is recommended to seek assistance from a professional electrician to complete this step.

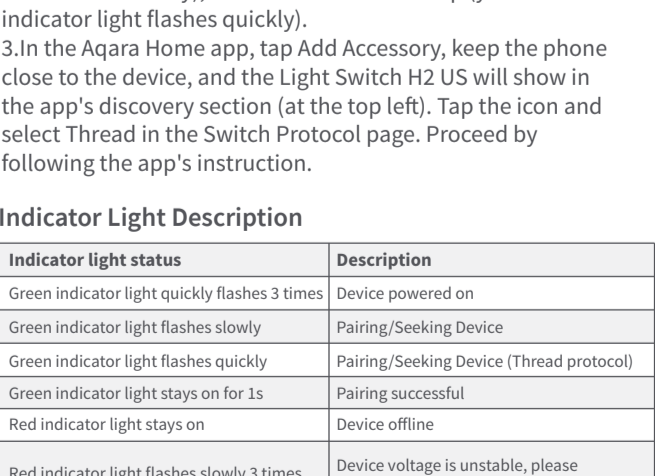

2 Buttons, 2 Channels

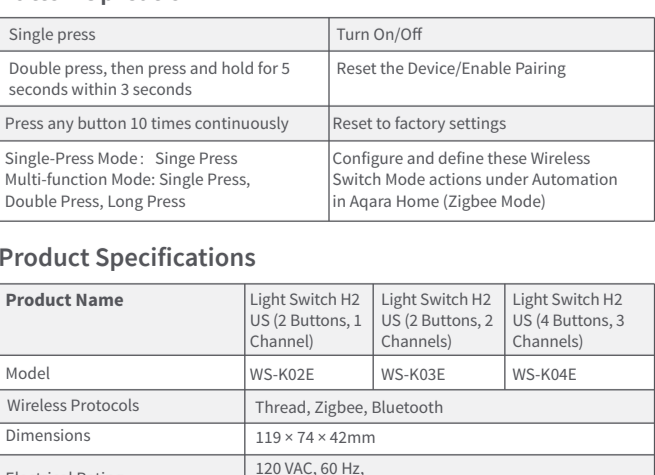

4 Buttons, 3 Channels

3. Mount the switch unit to the wall electrical box with the attached screws. Then mount the frame to the switch unit with screws, and attach the faceplate cover to the frame.

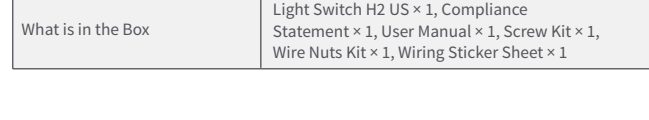

4. Turn on the power at the circuit breaker and test the switch by pressing the upper button. If the wired light can be controlled by the upper button, the switch is functioning correctly.

5. In the Aqara Home app, tap Add Accessory, choose Light Switch H2 US. Scan the Matter QR Code on the paper manual to add the device to the app. The following Quick Setup section will introduce the network configuration methods for both Zigbee and Thread protocols.

* If the QR code on the paper manual is lost, you can open the product cover and scan the QR code on the metal frame of the product.

Quick Setup

To use the device with a particular Matter ecosystem (Thread Mode), a Matter Controller of this ecosystem and a Thread Border Router are required.

1. Double-press any button, then press and hold it for 5 seconds until the green indicator light starts blinking. This indicates that the device is in pairing mode.
2. Open the app that supports Matter, scan the Matter code on the manual or product, or enter the setup code to add the device to the app.
3. Proceed following the app's instruction.

To use the device in Aqara Home (Thread Mode), an Aqara Hub with border router function (for example, Hub M3) is required:

1. Double-press any button, then press and hold it for 5 seconds until the green indicator light starts blinking. This indicates that the device is in pairing mode.
2. In the Aqara Home app, tap Add Accessory, choose Light Switch H2 US. Scan the Matter code on the manual or product or enter the setup code to add the device to the app. Select Thread on the Switch Protocol page.
3. Proceed by following the app's instruction.

To use the device in Aqara Home (Zigbee Mode), an Aqara Zigbee Hub is required:

1. Double-press any button, then press and hold it for 5 seconds until the green indicator light starts blinking. This indicates that the device is in pairing mode.
2. In the Aqara Home app, tap Add Accessory, keep your phone close to the device, and Light Switch H2 US will appear in the app's discovery section (at the top left). Tap the icon and select Zigbee on the Switch Protocol page.
3. Proceed by following the app's instruction.

Regarding Dual Protocol (Thread/Zigbee) Switching

Q: How to switch from Thread protocol to Zigbee protocol?

- A:
1. Install the Aqara Home app, and enable Wi-Fi and Bluetooth.
 2. Reset the device to factory settings (press any button 10 times continuously) to enter network setup (the first time you add the device it will automatically begin pairing), with its green indicator light flashing quickly.
 3. In the Aqara Home app, tap Add Accessory, scan the Matter code on the manual or product, then select Zigbee on the Switch Protocol page. Proceed by following the app's instruction.

Q: How to switch from Zigbee protocol to Thread protocol?

- A:
1. Install the Aqara Home app, and enable Wi-Fi and Bluetooth.
 2. Reset the device to factory settings (press any button 10 times continuously), then enter network setup (yellow indicator light flashes quickly).
 3. In the Aqara Home app, tap Add Accessory, keep the phone close to the device, and the Light Switch H2 US will show in the app's discovery section (at the top left). Tap the icon and select Thread in the Switch Protocol page. Proceed by following the app's instruction.

Indicator Light Description

Indicator light status	Description
Green indicator light quickly flashes 3 times	Device powered on
Green indicator light flashes slowly	Pairing/Seeking Device
Green indicator light flashes quickly	Pairing/Seeking Device (Thread protocol)
Green indicator light stays on for 1s	Pairing successful
Red indicator light stays on	Device offline
Red indicator light flashes slowly 3 times	Device voltage is unstable, please connect to a higher power load
Yellow indicator light flashes quickly	Seeking device (Zigbee protocol)

Button Operation

Single press	Turn On/Off
Double press, then press and hold for 5 seconds within 3 seconds	Reset the Device/Enable Pairing
Press any button 10 times continuously	Reset to factory settings
Single-Press Mode: Single Press, Double Press, Long Press	Configure and define these Wireless Switch Mode actions under Automation in Aqara Home (Zigbee Mode)

Product Specifications

Product Name	Light Switch H2 US (2 Buttons, 1 Channel)	Light Switch H2 US (2 Buttons, 2 Channels)	Light Switch H2 US (4 Buttons, 3 Channels)
Model	WS-K02E	WS-K03E	WS-K04E
Wireless Protocols	Thread, Zigbee, Bluetooth		
Dimensions	119 × 74 × 42mm		
Electrical Rating	120 VAC, 60 Hz, Max 10 A (Resistive Load or Incandescent), μ		
Minimum Power	5 W (No Neutral), Unlimited (With Neutral), general purpose		
Thread Operation Frequency	2400-2483.5Mhz		
Thread Maximum Output Power	≤ 13 dBm		
Bluetooth Operation Frequency	2400-2483.5Mhz		
Bluetooth Maximum Output Power	≤ 13 dBm		
Operating Temperature	0°C ~ 40°C (32°F ~ 104°F)		
Operating Humidity	0 ~ 95% RH, no condensation		
What is in the Box	Light Switch H2 US × 1, Compliance Statement × 1, User Manual × 1, Screw Kit × 1, Wire Nuts Kit × 1, Wiring Sticker Sheet × 1		